

Hazlux® AH1 Series

A shock and vibration resistant lighting fixture, designed for use in marine and wet locations, and a variety of hazardous areas.

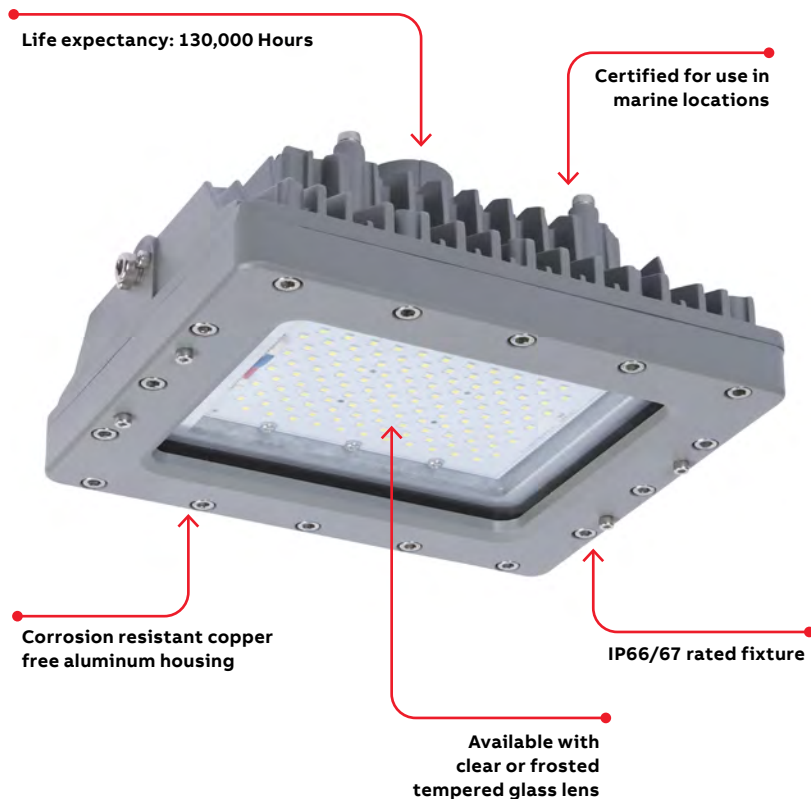

CLASSIFICATION

CLASS I	
Division 1	Groups B, C, D
Division 2	Groups A, B, C, D
CLASS II	
Division 1	Groups E, F, G
CLASS III	

Classification may vary upon light source and wattage. For details, see thermal performance chart on p. 25.

CERTIFICATIONS



Applications

Power plants
Paper mills
Wastewater treatment plants
Chemical processing
Petrochemical

Hazlux® AH1 Series

Key features and benefits

Features

- Temperature range 40W and 50W models: -40°F to 149°F (-40°C to 65°C)
- Temperature range 60W model: -40°F to 147°F (-40°C to 64°C)
- Shock and Vibration resistant (5G)
- Exposed hardware made of stainless steel
- Sealed to IP66 and IP67

Housing

- Housing made of copper-free aluminium
- Anti-corrosion housing (tested for 1000hrs ASTM B117-11)
- Tempered glass lens is impact and thermal shock resistant
- Lens tested to IK08
- High temperature silicone gasketing

LED

- Efficacy 150 Lumens/w
- Lumen output from 6,499 Lumens to 8,514 Lumens
- Nichia LED's
- CRI Ra>75

Electrical

- 120Vac-277Vac: 40W and 60W
- 347Vac-480Vac: 50W
- Frequency: 50/60Hz
- Power factor .95
- Driver efficiency 90%
- Surge protection standard at 4KV. Contact your sales representative if higher protection is required.

Mounting

- Pendant mount
- Optional yoke/pipe bracket for trunnion wall or pole mount

T-code chart

Fixture	40 watt	50 watt	60 watt
C1D1	T6	T6	T6
C1D2	T4	T4A	T4
CIID1	T6	T6	T5

Lighting output

Fixture	40 watt	50 watt	60 watt
Lumen output	6499	7179	8514
Lumen per watt*	150	150	150

*Value taken with T5 beam angle

Approvals

- Rated to CUL 844, 1598, 1598A Marine

Warranty

- 5 years

Mounting

Pendant Mount



Yoke/Pipe Bracket

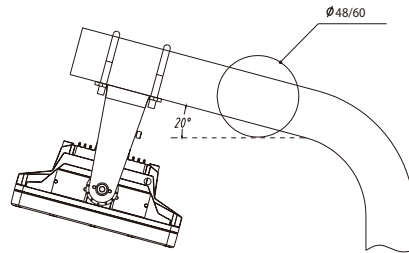

PB02 - Yoke/Pipe Bracket (SUS 304) Stainless steel

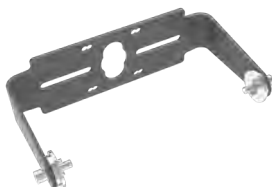

PC01 - Pipe clamp (1 pair)



PC01 = Pipe clamp (M8*48mm) for pole Ø 1-7/8" (48 mm)

PC02 - Pipe clamp (1 pair)



PC02 = Pipe clamp (M8*60mm) for pole Ø 2-3/8" (60 mm)

WG05 - Stainless steel wire guard

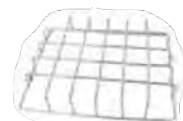

Note: Wall mount bracket required for Pipe installation.

Hazlux® AH1 Series

Photometry

Type III

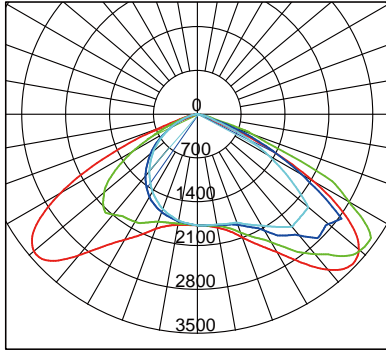

- C0/180,134.6
- C30/210,133.3
- C60/240,98.3
- C90/270,102.0

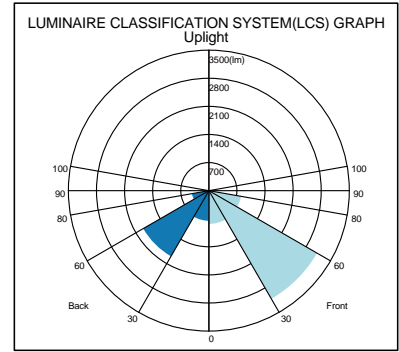
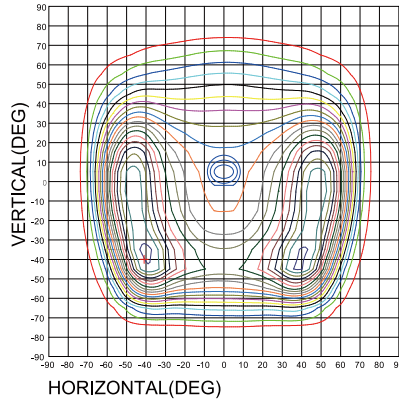

BUG (Back, Up, Glare) Rating: B2-U0-G1

Type V

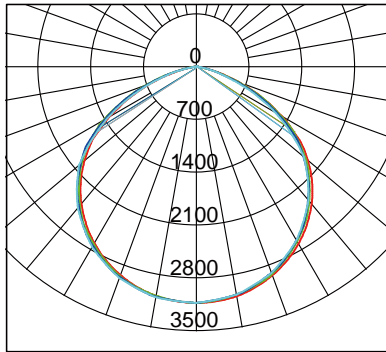

- C0/180,112.5
- C30/210,113.7
- C60/240,112.9
- C90/270,111.4

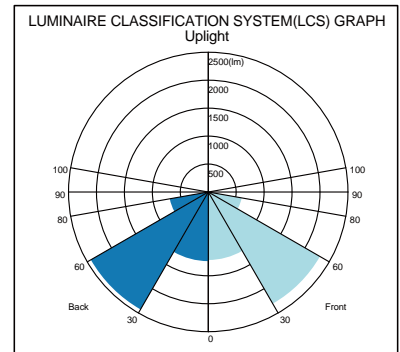
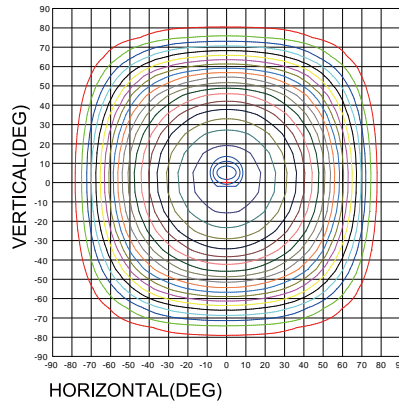

BUG (Back, Up, Glare) Rating: B3-U0-G1

Dimensions

Dimensions are approximate and subject to change

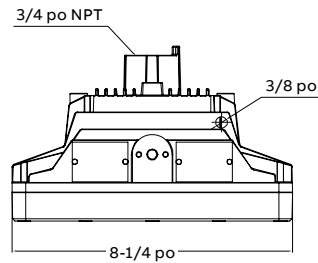
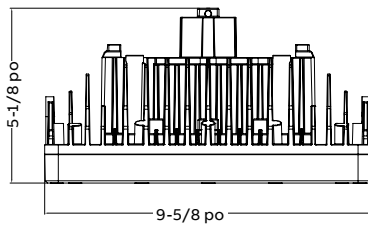

Hazlux® AH1 Series

Numbering system

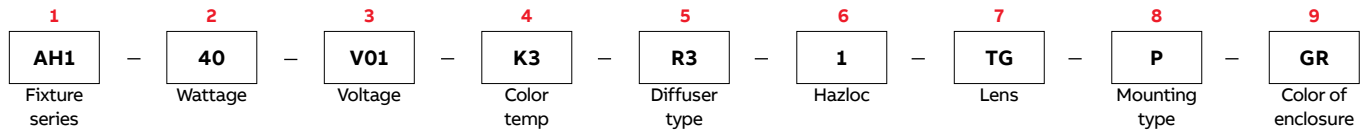

01. Lighting fixture

Part	Part number	Description
1 Fixture series	AH1	Hazlux LED Class I Div 1
2 Wattage	40	40 watts
	50	50 watts
	60	60 watts
3 Voltage	V01	120-277V (40W and 60W only)
	V04	347-480V (50W only)
4 Color temp	K3*	3000K
	K4*	4000K
	K5	5000K
5 Diffuser type	R3*	Type 3 Diffuser
	R5	110° (no diffuser)
6 Hazloc	1	C1D1
7 Lens	TG	Clear glass
	FG*	Frosted glass
8 Mounting type	P	NPT 3/4 pendant mount
	U*	NPT 3/4 pendant mount + U-bracket
9 Color of enclosure	GR	Gray

* Longer lead time, contact your sales representative for more details.